

PART NO.:	TITLE:	USED BY: Bolton T.	SCALE: NTS	ORDER NO: -	PACKAGE SHEET: OF
SHEET: OF:	P-100, S/S DRIVE-UP DISPENSER	DATE:	DRN BY: Bolton T. DATE: 11/02/07	CUSTOMER: FENCO	

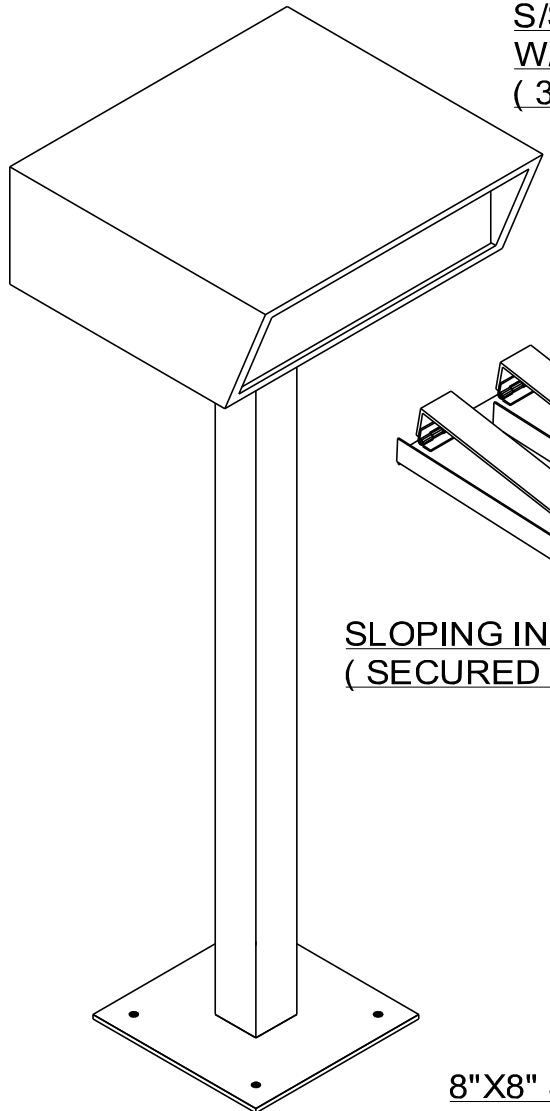

S/S FORMS DISPENSER
W/ PAINTED ADJ POST
(31" TO 40")

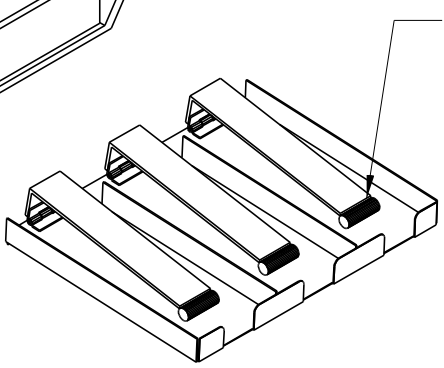

3-7/8"W x 9-1/4"D
(3) SLOPING
COMPARTMENTS

SLOPING INSERT WITH PAPER WEIGHT
(SECURED INSIDE)

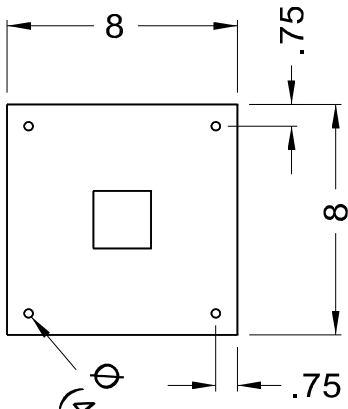

8"X8" SQ PLATE
W/ (4) 5/16" DIA HOLES

Ø .313
(4 PLCS)

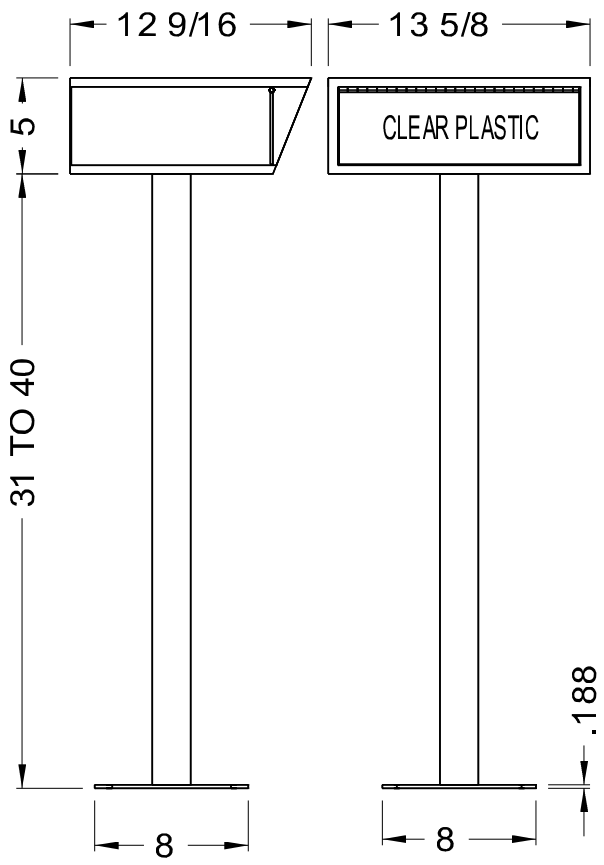

Last Update: 11/02/2007 - Bolton T.

Fenco
Undercounter & Forecounter Equipment
P.O. BOX 1238 BURLINGTON, NJ 08016-0516
www.fencobankequipment.com

PART NO.:	TITLE:	USED BY: Bolton T.	SCALE: NTS	ORDER NO: -	PACKAGE SHEET: OF
SHEET: OF:	INSERT, P-100	DATE:	DRN BY: Bolton T. DATE: 11/02/07	CUSTOMER: FENCO	

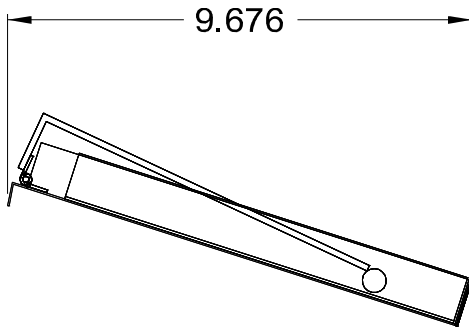
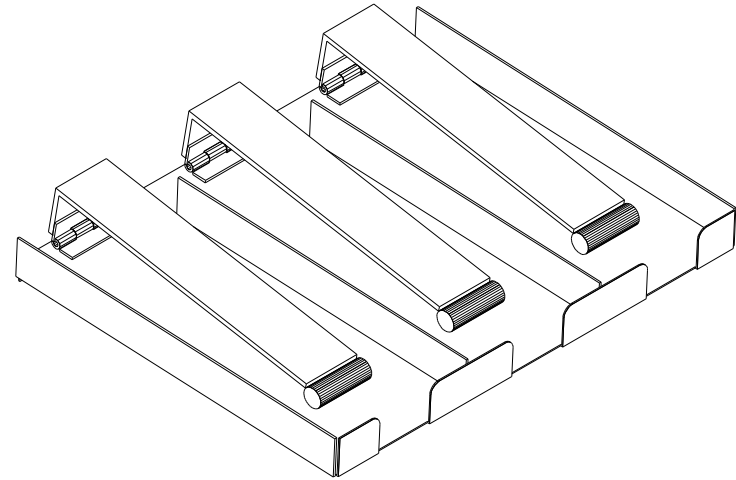
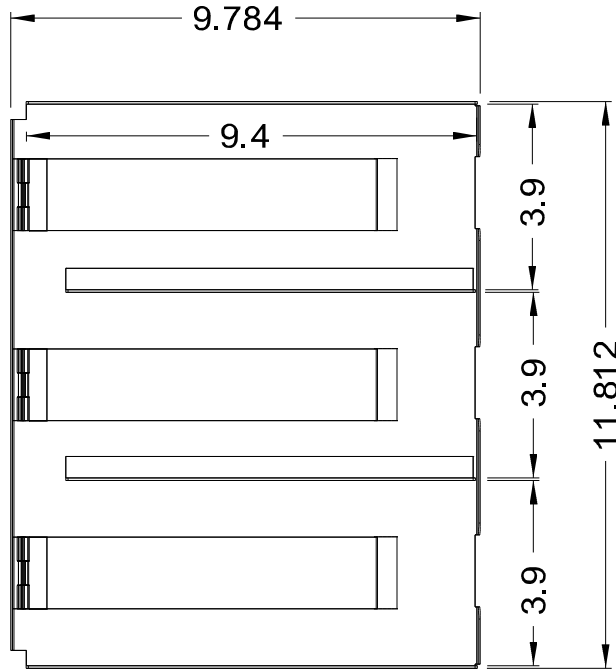

Last Update: 11/02/2007 - Bolton T.

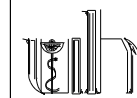

Fenco

Undercounter & Forecounter Equipment
P.O. BOX 1238 BURLINGTON, NJ 08016-0516
www.fencobankequipment.com